

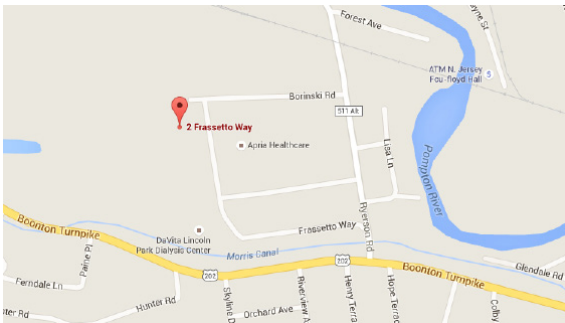

Lease

2 Frassetto Way, Lincoln Park, NJ

14,400± sq ft
includes Office



Specs

- Ceiling Heights:** 22" Clear
- Zoning:** Industrial
- Loading:** 2 Tailboards, 1 Drive-in
- Parking:** Ample
- Power:** 3000 @440 Phase 3
- Sprinklers:** 100% Wet
- Utilities:** City Water, Sewer, Gas

About Saddleback Real Estate Developers:

Saddleback Real Estate Developers specializes in industrial properties throughout the state of New Jersey. As a prominent commercial real estate development firm, owners Salvatore Frassetto and Terry Frassetto collectively provide more than 80 years of expertise in the New Jersey marketplace. Saddleback owns and manages over 20 industrial properties and has developed more than 20 million square feet of real estate. Saddleback specializes in revitalizing and repositioning distressed properties while offering quick and streamlined closings.

Saddleback takes pride in New Jersey and in projects both large and small and is currently looking for new properties of all types to add to their portfolio. Contact us to discuss commercial real estate.

Visit Saddleback Real Estate Developers at www.SaddlebackNJ.com.

Saddleback Real Estate Developers
 23 Kulick Road
 Fairfield, NJ 07004
 Phone: 973-227-3333
 Fax: 973-767-1303

X 303 for Sal Frassetto
 Cell: 201-673-6001
SFrassetto@SaddlebackNJ.com

X 302 for Terry Frassetto
TFrassetto@SaddlebackNJ.com

X 309 for Carmine Marabello
 Cell: 201-914-9131
CMarabello@SaddlebackNJ.com



Lease

2 Frassetto Way, Lincoln Park, NJ

14,400± sq ft
includes Office

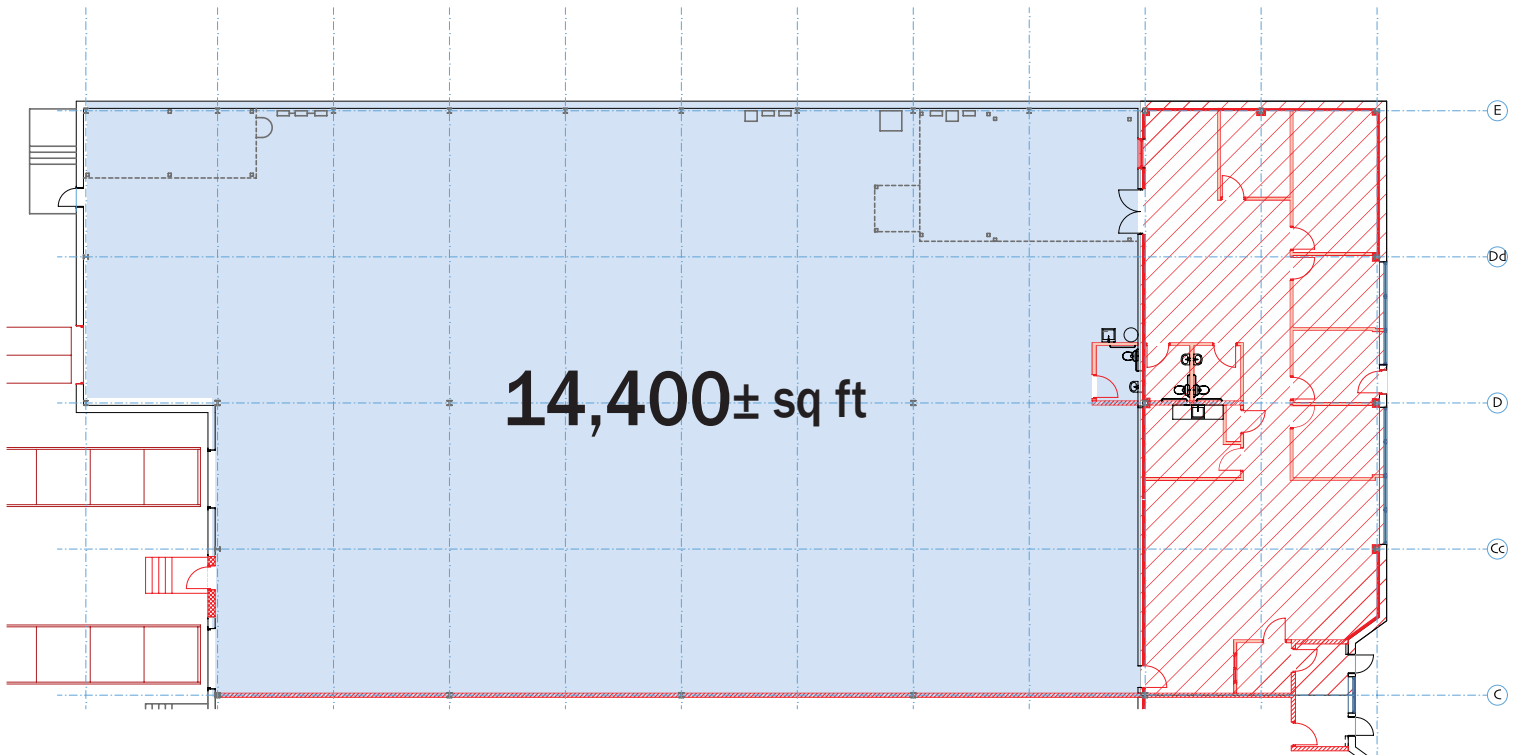
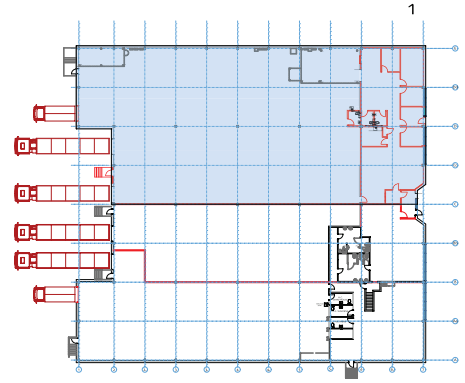

No warranty or representation, express or implied, is made as to the accuracy of the information contained herein, and same is submitted subject to errors, omissions, change of price, rental or other conditions, withdrawal without notice, and to any special listing conditions imposed by our principals.